

---

**CHIRON**

---

**25**

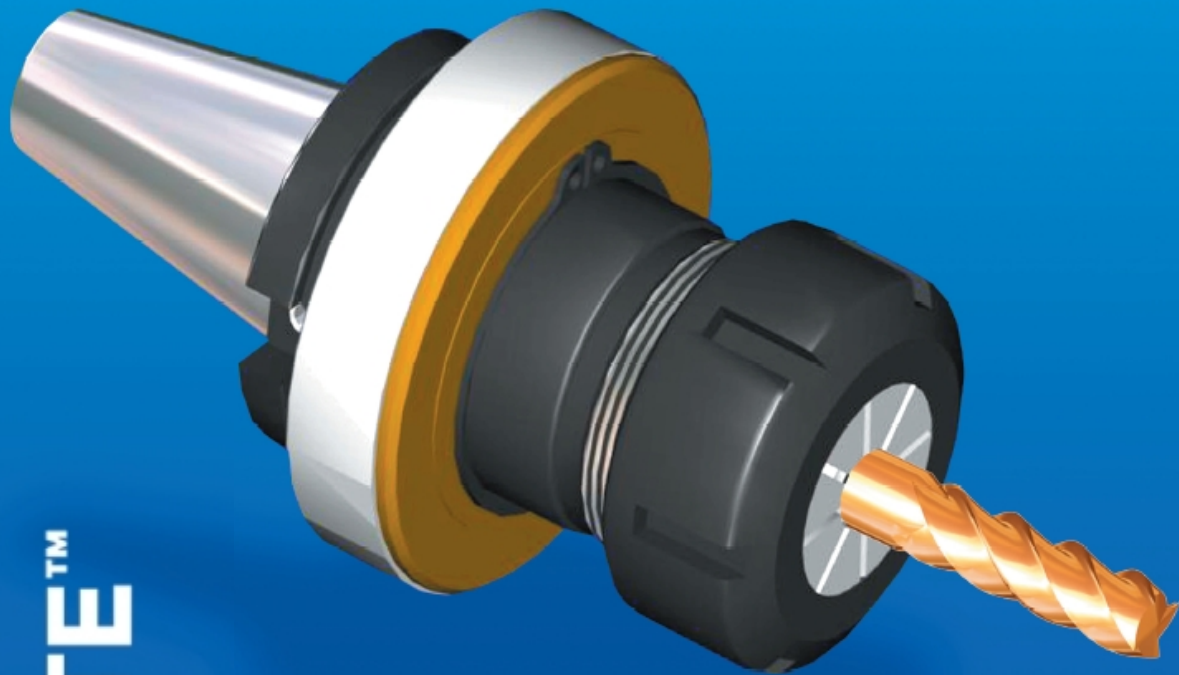







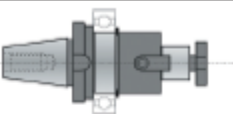
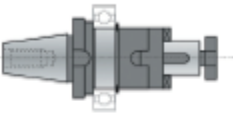
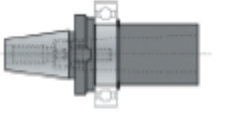
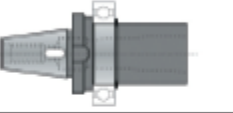
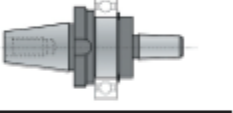

**NAREX@MTE™**

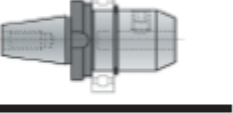

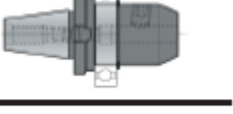
**2005**

KÓD – STRANA  
ORDER NR. - PAGE

<b>25.160</b>					
25.01					
<b>25.180</b>					
25.01					
<b>25.210</b>					
25.02					
<b>25.215</b>					
25.02					
<b>25.290</b>					
25.03					
<b>25.295</b>					
25.03					
<b>25.300</b>					
25.04					
<b>25.302</b>					
25.04					
<b>25.305</b>					
25.05					
<b>25.351/3</b>					
25.05					
<b>25.451/3</b>					
25.06					
<b>25.470</b>					
25.06					
<b>25.610</b>					
25.07					





**FRÉZOVACÍ TRNY CHIRON**  
 pro frézy s příčnou unášecí drážkou DIN 138  
**FRONTAL SHELL MILL ADAPTORS CHIRON**  
 for cutters with driving slot DIN 138

**CHIRON**

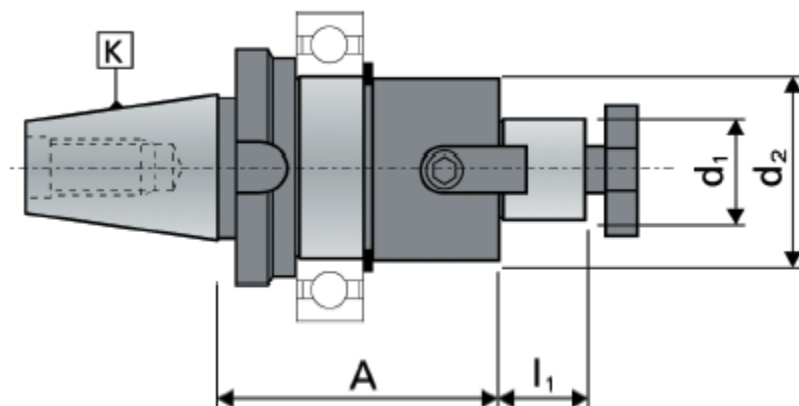
**25.160**



REF. <b>25.160</b>	K ISO	d <sub>1</sub> h6 mm	A mm	l <sub>1</sub> mm	d <sub>2</sub> mm		
25.160.30.16	30	16	40	17	32	89.100.16	89.171.16
25.160.30.22		22	40	19	40	89.100.22	89.171.22
25.160.30.27		27	51	21	48	89.100.27	89.171.27





**KOMBINOVANÉ FRÉZOVACÍ TRNY CHIRON**  
 pro frézy s podélnou nebo příčnou unášecí drážkou DIN 138  
**COMBINATION SHELL MILL ADAPTORS CHIRON**  
 for cutters with keyway or driving slot DIN 138

**CHIRON**

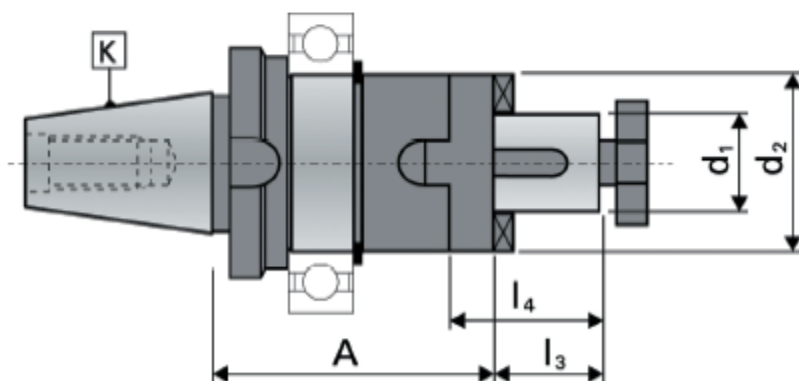
**25.180**

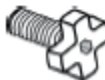

REF. <b>25.180</b>	K ISO	d <sub>1</sub> h6 mm	A mm	l <sub>3</sub> mm	l <sub>4</sub> mm	d <sub>2</sub> mm			
25.180.30.16	30	16	57	17	27	32	89.100.16	89.161.16	89.141.16
25.180.30.22		22	62	19	31	40	89.100.22	89.161.22	89.141.22
25.180.30.27		27	62	21	33	48	89.100.27	89.161.27	89.141.27



### REDUKCE CHIRON

pro stopky Morse (Mk) dle DIN 228-A

### REDUCING ADAPTORS CHIRON

for tools with Morse taper shank and drawbar thread DIN 228-A

CHIRON

25.210

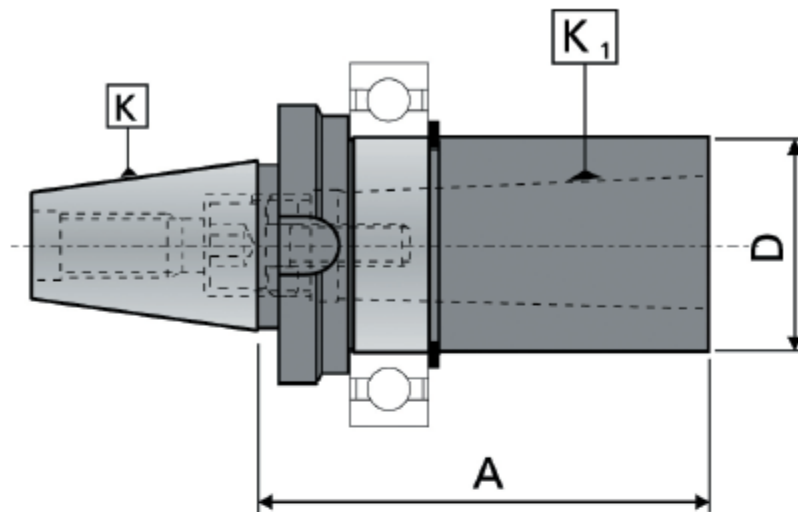

REF. 25.210

K  
ISO

K<sub>1</sub>  
MORSE

A  
mm

D  
mm



25.210.30.16

30

1

50

25

89.193.31

89.120.24

25.210.30.22

2

65

32

89.193.32

89.124.19

25.210.30.27

3

80

40

89.193.33

89.124.31



### REDUKCE CHIRON

pro stopky Morse dle normy DIN-228B

### REDUCING ADAPTORS CHIRON

for tools with Morse taper shank and drawbar thread DIN 228-B

CHIRON

25.215

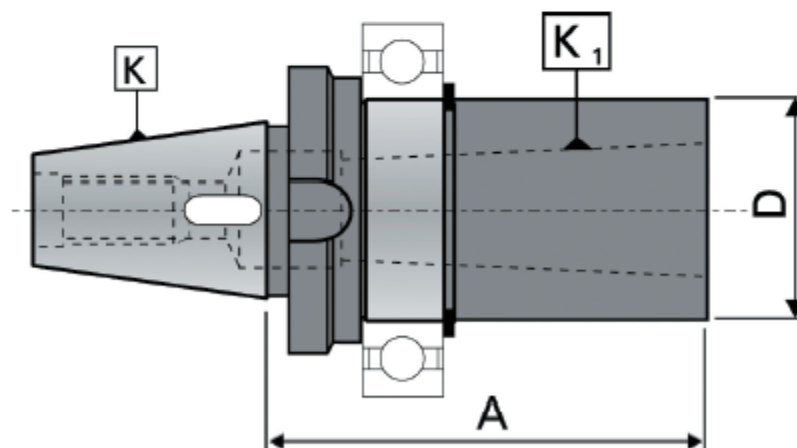

REF. 25.215

K  
ISO

K<sub>1</sub>  
MORSE

A  
mm

D  
mm



25.215.30.01

30

1

50

25

89.120.27

25.215.30.02

2

62

32

85.760.25.32/02

25.215.30.03

3

80

40

85.760.25.30/03



**PŘESNÁ UNIVERZÁLNÍ CNC VRTACÍ HLAVIČKA CHIRON**  
 pro pravý a levý směr otáček  
**CNC-UNIVERSAL PRECISION DRILL CHUCKS CHIRON**  
 for left and right and turn

CHIRON

25.290

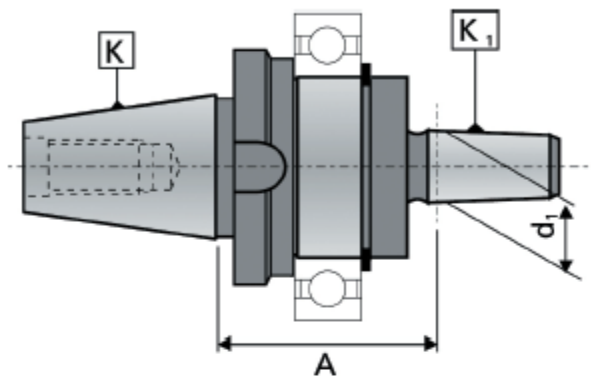

35.292  
 35.293  
 35.294  
 35.296

REF. 25.290	K ISO	K <sub>1</sub> DIN	A mm	d <sub>1</sub> mm
25.290.30.12	30	B-12	40	12,065
25.290.30.16		B-16	42	15,733





**SAMOSVORNÁ PŘESNÁ VRTACÍ HLAVIČKA CHIRON**  
 pouze pro pravý chod (otáčky)  
**SELF CLAMPING SHORT PRECISION DRILL CHUCKS CHIRON**  
 for right turn only

CHIRON

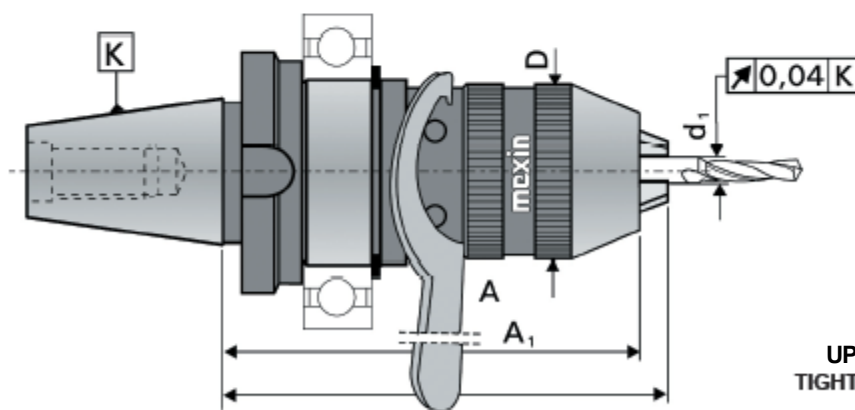
25.295



UPÍNACÍ MOMENT: } > 40 Nm  
 TIGHTENING TORQUE: }

REF. 25.295	K ISO	d <sub>1</sub> mm	D mm	A mm	A <sub>1</sub> max mm		 3
25.295.30.08	30	0 - 8	35,5	83	91	89.200.08	89.220.08



**DRŽÁKY CHIRON PRO UPÍNÁNÍ FRÉZ**  
**s válcovou stopkou s ploškou DIN 1835-B WELDON**  
**WELDON END MILL ADAPTORS CHIRON**  
 for cutters with cylindrical shank and weldon flat DIN 1835-B

CHIRON

25.300

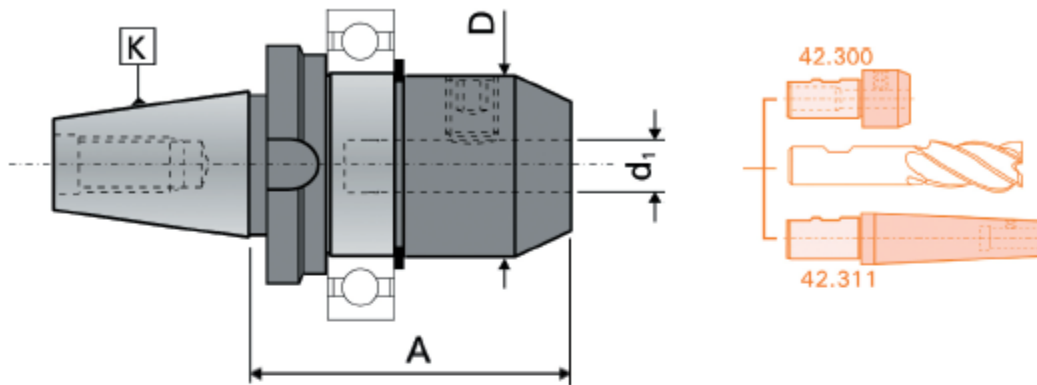

REF. 25.300	K ISO	d <sub>1</sub> H4 mm	A mm	D mm	
25.300.30.06	30	6	70	25	89.122.20
25.300.30.08		8	70	28	89.122.35
25.300.30.10		10	70	35	89.122.40
25.300.30.12		12	70	40	89.122.50
25.300.30.14		14	70	40	89.122.50
25.300.30.16		16	70	40	89.122.60
25.300.30.18		18	70	40	89.122.60
25.300.30.20		20	70	40	89.122.65



**KRÁTKÉ DRŽÁKY CHIRON PRO UPÍNÁNÍ FRÉZ**  
**s válcovou stopkou s ploškou DIN 1835-B**  
**SHORT END MILL ADAPTORS CHIRON**  
 for cutters and tooling with cylindrical shank and weldon flat DIN 1835-B

CHIRON

25.302

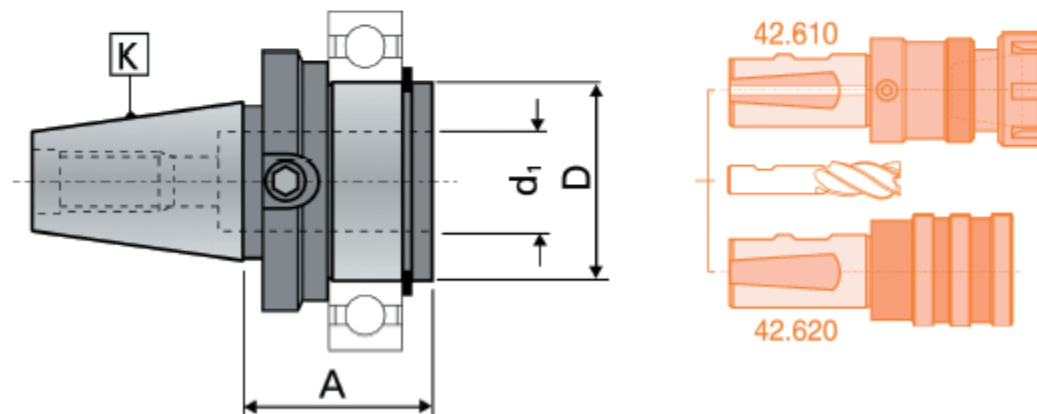

REF. 25.302	K ISO	d <sub>1</sub> H4 mm	A mm	D mm	
25.302.30.16	30	16	35	32	89.122.40
25.302.30.20		20	35	36	89.122.39





**DRŽÁKY CHIRON PRO UPÍNÁNÍ FRÉZ**  
**s válcovou stopkou s ploškou DIN 1835-E**  
**END MILL ADAPTORS TYPE WHISTLE-NOTCH CHIRON**  
 for tools with cylindrical shank and inclined flat DIN 1835-E

**CHIRON**

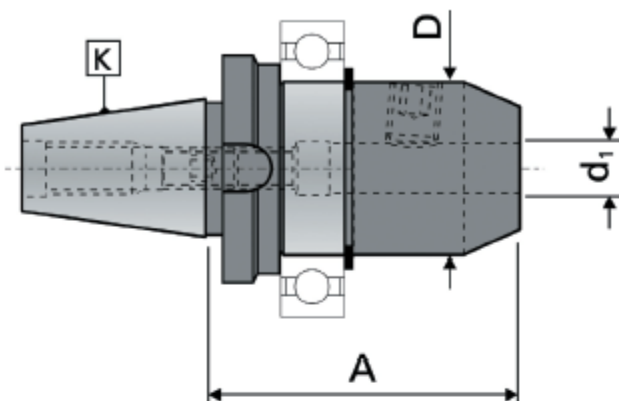
**25.305**



REF. <b>25.305</b>	K ISO	d <sub>1</sub> H4 mm	A mm	D mm		
25.305.30.06	30	6	70	25	89.122.15	89.122.20
25.305.30.08		8	70	28	89.122.21	89.122.35
25.305.30.10		10	70	35	89.122.37	89.122.40
25.305.30.12		12	70	40	89.122.43	89.122.49
25.305.30.14		14	70	40	89.122.43	89.122.49
25.305.30.16		16	70	40	89.122.51	89.122.59
25.305.30.18		18	70	40	89.122.51	89.122.59



**KLEŠTINOVÉ UPÍNAČE CHIRON PRO ER KLEŠTINY DIN 6499**  
 pro nástroje s válcovou stopkou dle DIN 1835-B  
**COLLET CHUCKS FOR DIN 6499 (ER) COLLETS CHIRON**  
 for tools with cylindrical shank DIN 1835-B

**CHIRON**



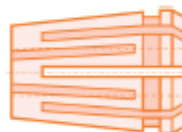
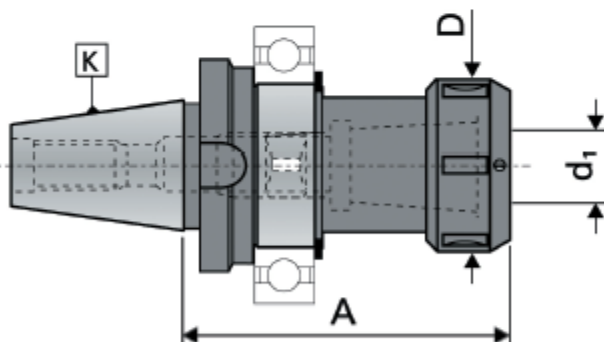

**25.351/3**



**80.394**

**MATICE S LOŽISKEM REF. XX.351**  
**WITH BALL BEARING NUT REF. XX.351**

**UPÍNACÍ MOMENT: } > 150 Nm - Ø20**  
**TIGHTENING TORQUE: }**

REF. <b>25.351</b>	A mm	 80.391	REF. <b>25.353</b>	A mm	 80.393	d <sub>1</sub> mm	D mm		
25.351.30.16	81	80.391.16	25.353.30.16	81	80.393.16	2 - 16	43	89.201.16	89.192.16
25.351.30.25	85	80.391.25	25.353.30.25	85	80.393.25	3 - 25	60	89.201.25	89.192.16

\* DODÁVKA BEZ KLÍČE

\* SUPPLIED WITHOUT WRENCH



**KLEŠTINOVÉ UPÍNAČE CHIRON PRO ER KLEŠTINY DIN 6499**  
 pro nástroje s válcovou stopkou dle DIN 1835-B  
**COLLET CHUCKS FOR DIN 6499 (ER) COLLETS**  
 for tools with cylindrical shank DIN 1835-B



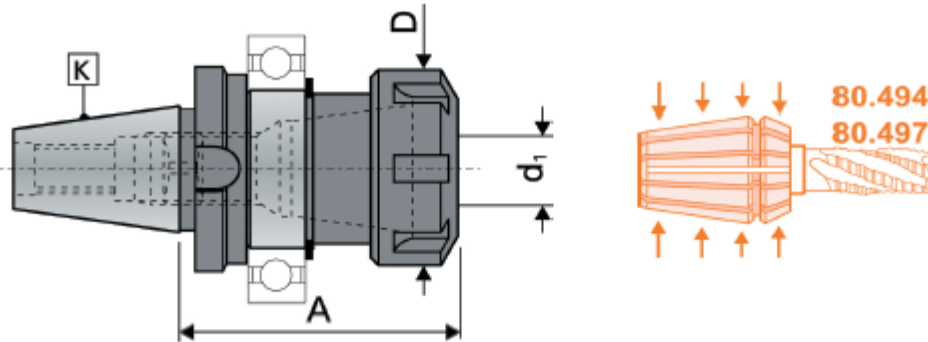

CHIRON

25.451/3



MATICE S LOŽISKEM REF. **XX.451**  
 WITH BALL BEARING NUT REF. **XX.451**

UPÍNAČÍ MOMENT:  
 TIGHTENING TORQUE: } > 150 Nm - Ø20

REF. <b>25.451</b>	K ISO	A mm	 80.491/3		d <sub>1</sub> mm	D mm			
25.451.30.16	30	57,7	80.491.16	ER 25	1 - 16	42	89.202.16	89.192.16	
25.451.30.20		64	80.491.20	ER 32	2 - 20	50	89.202.20	89.192.22	
25.451.30.26		95,3	80.491.26	ER 40	3 - 26	63	89.202.26	89.192.26	
<b>REF. 25.453</b>									
25.453.30.10	30	55	80.493.10	ER 16	0,5-10	32	89.202.10	89.192.10	
25.453.30.10/100		100	80.493.10	ER 16	0,5-10	32	89.202.10	89.192.10	
25.453.30.13		55	80.493.13	ER 20	1 - 13	35	89.202.13	89.192.13	
25.453.30.13/100		100	80.493.13	ER 20	1 - 13	35	89.202.13	89.192.13	
25.453.30.16		55	80.493.16	ER 25	1 - 16	42	89.202.16	89.192.16	
25.453.30.20		60	80.493.20	ER 32	2 - 20	50	89.202.20	89.192.20	
25.453.30.26		91	80.493.26	ER 40	3 - 26	63	89.202.26	89.192.26	
* DODÁVKA BEZ KLÍČE					* SUPPLIED WITHOUT WRENCH				



**POLOTOVAR**  
 pro upínače, vyvrtávací tyče  
**BLANK ADAPTORS CHIRON**

CHIRON

25.470

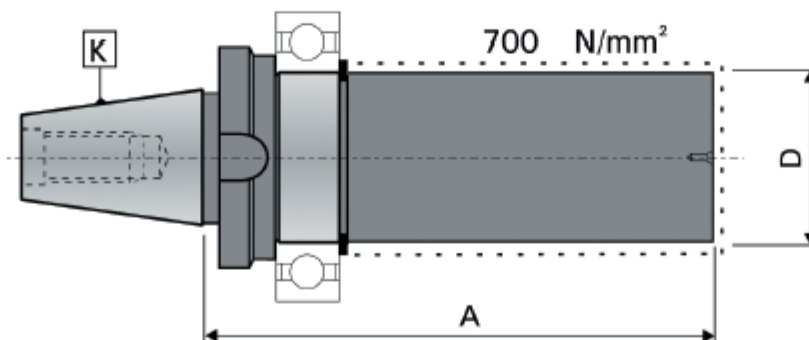

REF. <b>25.470</b>	K ISO	D mm	A mm
25.470.30.40	30	40	160
25.470.30.60		60	160





## ZÁVITOŘEZNÁ HLAVA S AXIÁLNÍ KOMPENZACÍ upínání závitníků pomocí ER kleštin s vnitřním čtyřhranem TAPPING HEAD WITH AXIAL COMPENSATION Hold tape with DIN 6499 (ER) collets and with inner coolant.

CHIRON

25.610

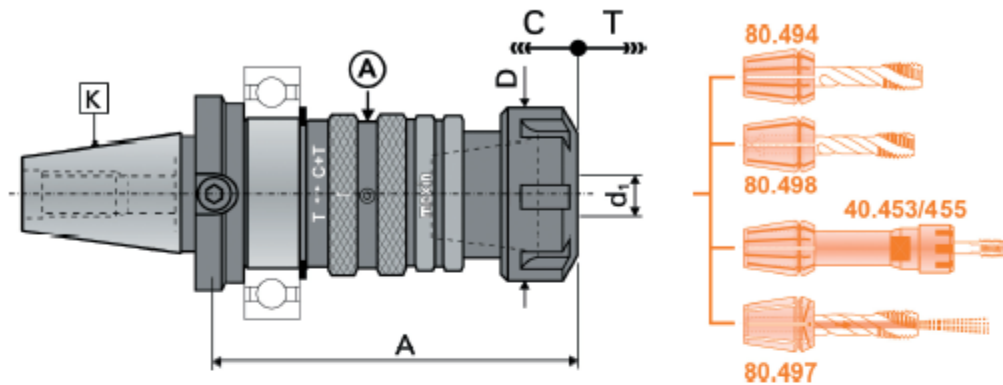

Kompensace stlačením (C) a vytažením (T).  
Stlačení může být blokováno otočením kroužku doprava (A)  
pro řízení hloubku závitů.  
Přívod chlazení středem.

Compensation in compression (C) and tension (T)  
Compression can be blocked by turning the rear ring (A)  
Control of thread depth.  
Central coolant supply.

REF. 25.610

K  
ISO



A  
mm

D  
mm

C  
mm

T  
mm



25.610.30.12

30

ERF 16

M3 - M12

100

28

7,5

6

80.496.10

89.202.10



## PRACOVNÍ SADA ISO 40 DIN 69871-A EQUIPMENT KIT ISO-40, DIN OR BT

KIT

Sada obsahující Frézovací trny, Redukce, Přesnou vrtací hlavičku, Kleštinové upínače, Závitovací hlavičku, kleštiny a upínací kameny je vždy připravena pro použití.

The Kit includes Shell Mill Adaptors, Reducing Adaptors, Self-Clamping Short Precision Drill Chucks, Collet Chucks, Tapping Head and a range of Collets and Pull Studs, everything ready to be used.

### SADA OBSAHUJE - KIT CONTAINING

Num.	Ref.	Popis / Description
1	11.160.40.22	Frézovací trn Ø22 / Shell Mill Adaptor Ø22
1	11.160.40.27	Frézovací trn Ø27 / Shell Mill Adaptor Ø27
1	11.215.40.02	Redukce pro Mk2 / Reducing Adaptor with Morse Taper 2
1	11.215.40.03	Redukce pro Mk2 / Reducing Adaptor with Morse Taper 2
1	11.295.40.13	Přesná vrtací hlavička / Self-Clamping Drill Chuck Cap.13
1	11.300.40.06	Držák pro upínání fréz - WELDON Ø6 / End Mill Adaptor Weldon Ø6
1	11.300.40.08	Držák pro upínání fréz - WELDON Ø8 / End Mill Adaptor Weldon Ø8
1	11.300.40.10	Držák pro upínání fréz - WELDON Ø10 / End Mill Adaptor Weldon Ø10
1	11.300.40.12	Držák pro upínání fréz - WELDON Ø12 / End Mill Adaptor Weldon Ø12
1	11.300.40.16	Držák pro upínání fréz - WELDON Ø16 / End Mill Adaptor Weldon Ø16
1	11.300.40.20	Držák pro upínání fréz - WELDON Ø20 / End Mill Adaptor Weldon Ø20
4	11.453.40.20	Přesná univerzální CNC vrtací hlavička / CNC-Universal Drill Chuck DIN6499 (ER32)
8	80.494.20.XX	Sada kleštin ER32 DIN6499 / Set of Collets DIN 6499 (ER32) Ø 4 - 5 - 6 - 8 - 10 - 12 - 16 - 20 mm
1	89.200.13	Klíč / Key
1	89.202.20	Klíč / Key
15	85.XXX.XX.40	Unašeč. Specifikujte. / Pull Studs. Please indicate Model.





**ANTIVIBRAČNÍ FRÉZOVACÍ TRNY**  
 pro frézy s příčnou unášecí drážkou DIN 138  
**ANTIVIBRATORY SHELL MILL ADAPTORS**  
 for cutters with driving slot DIN 138

**A11.160**

**A20.160**

**SPECIÁLNĚ URČENO PRO VÝROBU FOREM A ZÁPUSTEK**  
**SPECIAL FOR MOULD AND DIE MAKERS**

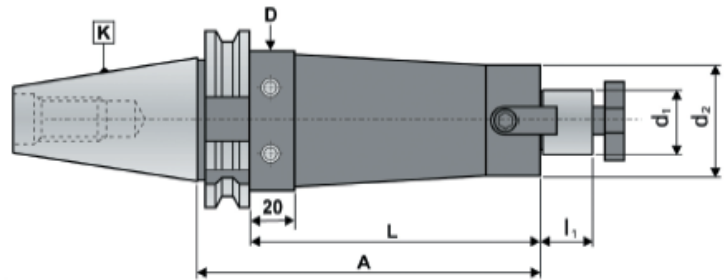

**POROVNÁNÍ PŘI POUŽITÍ ANTIVIBRAČNÍHO DRŽÁKU**  
**COMPARISON WHEN USING AN ANTIVIBRATORY TOOLHOLDER**

**Vibrace jsou redukovány až o 60% ve srovnání se standardním držákem oproti držáku vyrobeného s materiálu s antivibračními vlastnostmi.**

**Vibration reduced up to 60% compared to any other conventional shell mill adaptor, as they are manufactured with materials and mechanisms having antivibration properties.**

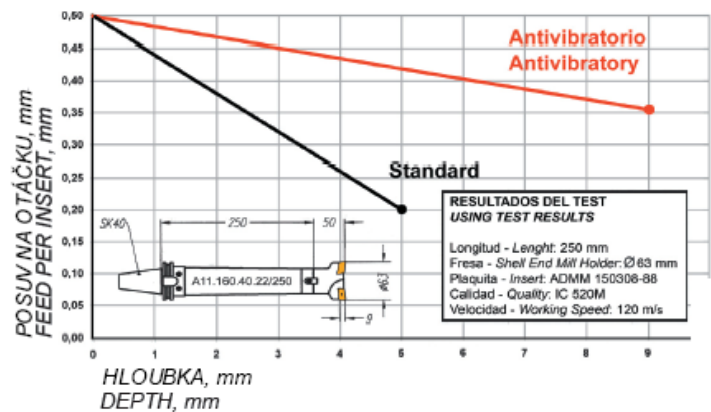

DIN 69871-A	L mm	D mm	JIS 6339 - BT	L mm	D mm	K ISO	d <sub>1</sub> h <sub>6</sub> mm	A mm	l <sub>1</sub> mm	d <sub>2</sub> mm
A11.160.40.16/150	131	50	A20.160.40.16/150	116	50	40	16	150	36	36
A11.160.40.16/200	181	50	A20.160.40.16/200	166	50			200	36	36
A11.160.40.16/250	231	50	A20.160.40.16/250	216	50			250	36	36
A11.160.40.16/300	281	50	A20.160.40.16/300	266	50			300	36	36
A11.160.40.22/150	131	50	A20.160.40.22/150	116	50		22	150	19	44
A11.160.40.22/200	181	50	A20.160.40.22/200	166	50			200	19	44
A11.160.40.22/250	231	50	A20.160.40.22/250	216	50			250	19	44
A11.160.40.22/300	281	50	A20.160.40.22/300	266	50			300	19	44
A11.160.40.27/150	131	50	A20.160.40.27/150	116	56		27	150	21	54
A11.160.40.27/200	181	50	A20.160.40.27/200	166	56			200	21	54
A11.160.40.27/250	231	50	A20.160.40.27/250	216	56			250	21	54
A11.160.40.27/300	281	50	A20.160.40.27/300	266	56			300	21	54
A11.160.50.16/150	131	80	A20.160.50.16/150	112	80	50	16	150	36	36
A11.160.50.16/200	181	80	A20.160.50.16/200	162	80			200	36	36
A11.160.50.16/250	231	80	A20.160.50.16/250	212	80			250	36	36
A11.160.50.16/300	281	80	A20.160.50.16/300	262	80			300	36	36
A11.160.50.16/400	381	80	A20.160.50.16/400	362	80			400	36	36
A11.160.50.22/200	181	80	A20.160.50.22/200	162	80		22	200	19	44
A11.160.50.22/250	231	80	A20.160.50.22/250	212	80			250	19	44
A11.160.50.22/300	281	80	A20.160.50.22/300	262	80			300	19	44
A11.160.50.22/400	381	80	A20.160.50.22/400	362	80			400	19	44
A11.160.50.22/500	481	80	A20.160.50.22/500	462	80			500	19	44
A11.160.50.27/200	181	80	A20.160.50.27/200	162	80		27	200	21	54
A11.160.50.27/250	231	80	A20.160.50.27/250	212	80			250	21	54
A11.160.50.27/300	281	80	A20.160.50.27/300	262	80			300	21	54
A11.160.50.27/400	381	80	A20.160.50.27/400	362	80			400	21	54
A11.160.50.27/500	481	80	A20.160.50.27/500	462	80			500	21	54
A11.160.50.32/200	181	80	A20.160.50.32/200	162	80		32	200	24	64
A11.160.50.32/250	231	80	A20.160.50.32/250	212	80			250	24	64
A11.160.50.32/300	281	80	A20.160.50.32/300	262	80			300	24	64
A11.160.50.32/400	381	80	A20.160.50.32/400	362	80			400	24	64
A11.160.50.32/500	481	80	A20.160.50.32/500	462	80			500	24	64



**ANTIVIBRAČNÍ DRŽÁK PRO DOKONČOVACÍ FRÉZY**  
 pro přední dokončovací frézu se závitovým upínáním  
**ANTIVIBRATORY END MILL ADAPTORS**  
 for frontal End Mill support screwed shanks

**A13.315**

**A23.315**

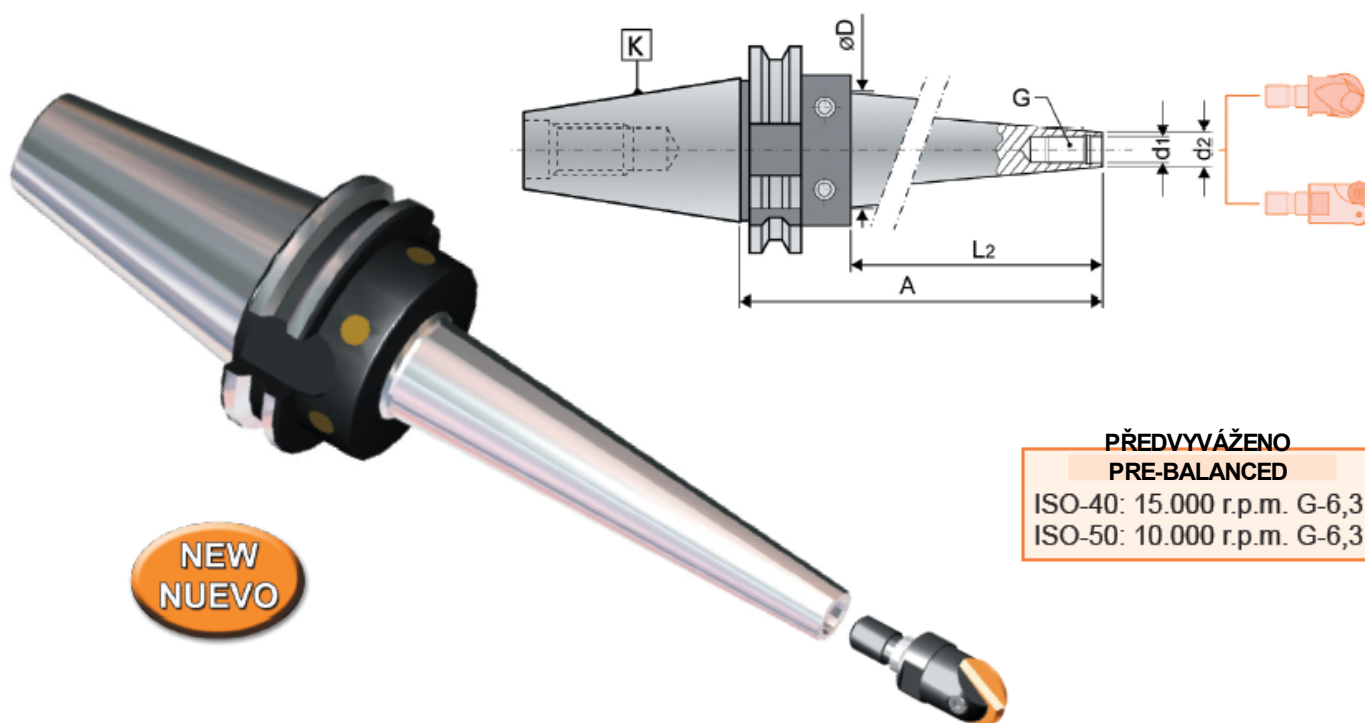

**PŘEDVYVÁŽENO**  
**PRE-BALANCED**  
 ISO-40: 15.000 r.p.m. G-6,3  
 ISO-50: 10.000 r.p.m. G-6,3

Antivibrační upínače pro dokončovací frézování jsou vyrobeny s materiálu s mechanickými antivibračními vlastnostmi. Standardní i extra dlouhá provedení jsou vhodná pro výrobu forem a speciální výrobu.

Antivibratory Shell Mill Adaptors manufactured with materials and mechanisms having antivibration properties. Standard and extra long lengths, suitable for moulding and special manufactures.

DIN 69871-AD+B	A mm	JIS B 6339 - BT	A mm	K ISO	d <sub>1</sub> mm	G mm	d <sub>2</sub> mm	L <sub>2</sub> mm	D mm
13.315.40.10/045	45	23.315.40.10/055	55	40	10,5	M10	18	25	20
13.315.40.10/070	70	23.315.40.10/080	80		10,5	M10		50	23
13.315.40.10/120	120	23.315.40.10/130	130		10,5	M10		100	29
13.315.40.12/045	45	23.315.40.12/055	55		12,5	M12	21	25	24
13.315.40.12/070	70	23.315.40.12/080	80		12,5	M12		50	26
13.315.40.12/120	120	23.315.40.12/130	130		12,5	M12		100	32
13.315.40.16/045	45	23.315.40.16/055	55		17	M16	29	25	32
13.315.40.16/070	70	23.315.40.16/080	80		17	M16		50	35
13.315.40.16/120	120	23.315.40.16/130	130		17	M16		100	40
13.315.50.12/070	70	23.315.50.12/090	90	50	12,5	M12	21	50	26
13.315.50.12/120	120	23.315.50.12/140	140		12,5	M12		100	32
13.315.50.12/170	170	23.315.50.12/190	190		12,5	M12		150	37
13.315.50.16/070	70	23.315.50.16/090	90		17	M16	29	50	35
13.315.50.16/120	120	23.315.50.16/140	140		17	M16		100	40
13.315.50.16/170	170	23.315.50.16/190	190		17	M16		150	45

ISO 50 držák podle DIN 69871 a JIS 6339-BT lze použít shodně s normou DIN 2080 při použití speciálního čepu a přízpusobení stroje (vliv usnášecích kamenů).

ISO 50 Axial compensation Toolholders as per DIN 69871 and JIS 6339-BT could become DIN 2080. Tapers by using the special pull stud.



Ref. A85.752.50.50

# CELKOVÝ PROGRAM UPÍNACÍCH DRŽÁKŮ A PŘÍSLUŠENSTVÍ

## TOOLHOLDERS AND ACCESSORIES PROGRAM

DIN 2080 **10**



NAREX@MTE™  
mexin  
2005

DIN 69871 **11 13**



NAREX@MTE™  
mexin  
2005

HSK DIN 69893-1 **16**



NAREX@MTE™  
mexin  
2005

JIS B 6339 - BT **20 23**



NAREX@MTE™  
mexin  
2005

**35 40 42 47 49 80 85**

DIN 238 JACOBS  
DIN 1875.4  
DIN 1075.9  
DIN 69109  
BILZ SYSTEM  
DIN 4536  
DIN 69871  
JIS 6339-BT



NAREX@MTE™  
mexin  
2005

**18 19 26 28 29**

PORTAHERRAMIENTAS PARA LA INDUSTRIA DE LA MADERA



NAREX@MTE™  
mexin  
2005

**TECNO**  
DRILL CHUCKS, S.L.

TECNO DRILL CHUCKS S.L.  
Cami de Lourdes nº1  
E-08358 ARENYS DE MUNT  
Barcelona  
SPAIN

Tel: +34 93 793 98 20  
Fax: +34 93 795 13 57  
Web: [www.mexin.es](http://www.mexin.es)  
Email: [mexin@mexin.es](mailto:mexin@mexin.es)

DISTRIBUIDOR - DISTRIBUTOR:

**NAREX@MTE™**  
machine tools equipment

NAREX MTE s.r.o.  
Moskevská 63  
CZ-101 00 Praha 10  
Czech Republic

tel.: +420 246 002 321  
+420 246 002 249  
fax.: +420 246 002 335  
e-mail: [sales@narexmte.cz](mailto:sales@narexmte.cz)  
<http://www.narexmte.cz>